

Integral L VIP in the thickness: 68 mm (special thicknesses possible)

Fire protection EI₂ 30-C5-S₂₀₀ acc. to EN 16034

EN 14351-1

Proved special construction: door blank for apartment doors, external and special areas



Tested accord. to DIN EN 1121

Test climate **c, d, e** from 68 mm class 3 (c), 3 (d), 3 (e)

acc. to DIN EN 12219:2000-06

Burglar resistance RC2/RC3, external door acc. to EN 14351-1

Hinge side

Reducible by 100 mm

Lock side

not reducible

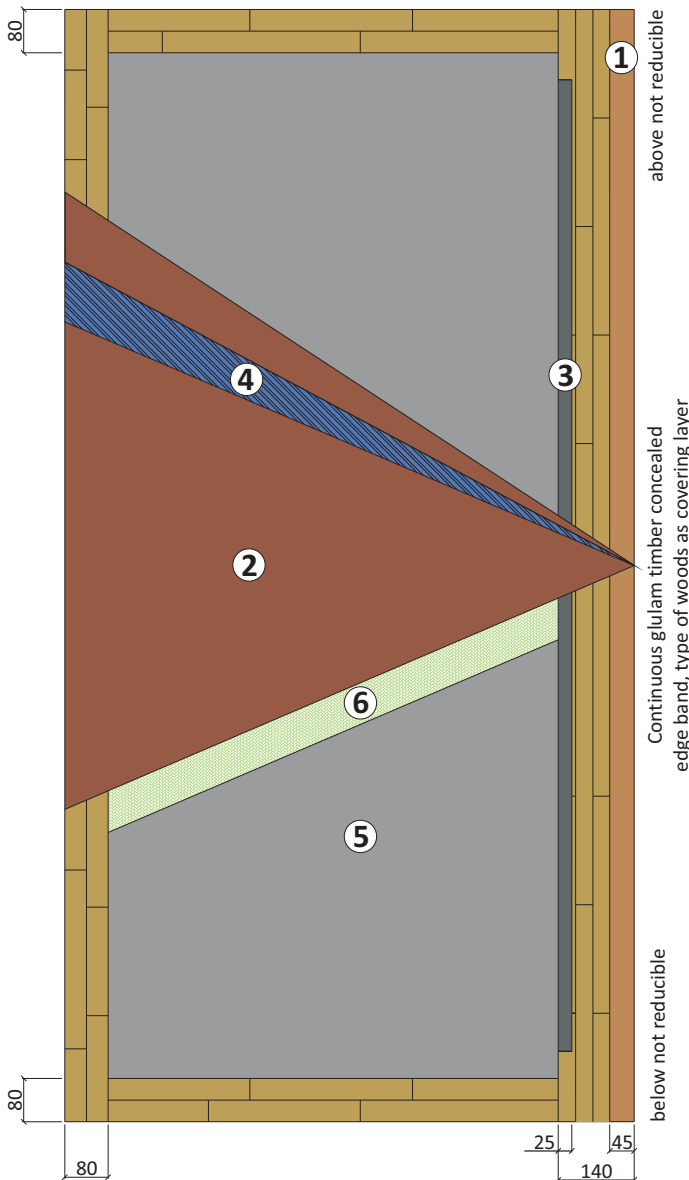

1. Wing frame

- **Lock side:** lamellas in type of wood/colour matching the covering layer. Width approx. 45 mm, glued to inner frame
- **Hinge side:** flawless glulam timber concealed edge band, finger jointed as reduction area, type of wood as lock side
- **Above:** 160 mm flawless glulam timber concealed edge band as reduction area, type of wood as lock side
- **Below:** 160 mm glulam timber concealed edge band according to factory's choice

2. Covering layers (see at page 22 „Plywood covering layers“ data sheet no. 515) Plywood Exterior glued according to DIN EN 314, class 3, MDF-Exterior with a thickness of 3 mm. **Water-repellent treatment of MDF with VARIOTEC Protekt, data sheet no. 471.** HPL wating acc. to Exterior collection.

3. FKV technology (Fibre-plastic composite) as a metal-free reinforcement.

Design example:

Sound protection	U _p value	VIP thickness
42 dB	0,72 W/(m ² K)	15 mm
37 dB	0,61 W/(m ² K)	25 mm
30 dB	0,56 W/(m ² K)	35 mm

U_p value for size 2250 x 1050 mm

4. ASS Stabilisation layers on both sides as vapour barrier gluing stiff against shearing and tension.

5. Core insulation

VIP construction core (VIP=vacuum insulation panel), construction-biologically tested, recyclable, not suitable for subsequent cut-outs/boreholes (**do not drill!**).

6. Internal reinforcement (insert)

PUR gluing of the whole construction.

The functionality, withstand capability, weathering qualities of the surfaces, and all the other characteristics which can be expected of an entry door, depend on the adherence of technical guidelines, coatings on dimensionally stable external parts made of wood, especially on windows and outside doors. Leaflet no. 18 and VOB (German Construction Contract Procedures) part A 10.3 as well as the RAL quality and test requirements for the construction of wooden entry doors RAL GZ 996. The application recommendations for external building elements from the ift-Rosenheim and VFF-Frankfurt am Main, as well as the guidelines of the EN 14351-1:2006+A1:2010 have imperatively to be maintained.

