

VARIO PUR *Smart* in the thicknesses: 68, 78 mm

EN 14351-1

- for covering coatings
- with MDF melamine external board

Tested accord. to DIN EN 1121

 Test climate **c, d, e** from 68 mm class 3 (c), 3 (d), 3 (e)
 acc. to DIN EN 12219:2000-06

- ✓ thinner top coats, thus elegant optic of edges
- ✓ thicker door body = higher stability
- ✓ excellent vapour barrier function (WKI tested)
- ✓ hard, resistant surfaces similar to HPL can be realised

Standard sizes:	Reducible to:
2150 / 2250 x 950 mm	1930 / 2030 x 850
2150 / 2250 x 1050 mm	1930 / 2030 x 950
2150 / 2250 x 1150 mm	1930 / 2030 x 1050

1. Wing frame

Pine or redwood finger jointed glulam frame, according to factory's choice.

2. Covering layers

MDF melamine external board

3. FKV technology (fibre-plastic composite)

as a metal-free reinforcement.

Thermal insulation PUR construction core, free of HFCKW.

Door thickness in mm	68	78
Sound insulation R_w in dB „standard design“	30	30
U_p -value in $W/(m^2K)$	0,92	0,81
U_p -values for size 2250 x 1050 mm		

Additional sound insulation only possible for type Allround F2, Allwetter/W, Integral.

4. Core insulation

 PUR construction core, free of HFCKW, construction-biologically tested, recyclable, jointless and non-positive directly foamed and thus **without thermal bridges**.

5. Internal reinforcement (Insert)

 Standard: **MFP** (multifunction panel) as a reinforcement for cutouts or as a basis for glazing beads, false edges and glazing beads on both sides. Option: Insert in **plywood** or **MDF** for glazing beads on one side.

Reducible in height by 220 mm (minimum width of the glulam timber concealed edge band 50 mm), from case to case reducible in width by 100 mm only on the **hinge side**. Please take into account ground seal + rabbet design before reducing.

Internal dimensions for cutouts/10 mm reserve per side

- with width 950 : 610 mm
- with width 1050 : 710 mm
- with width 1150 : 810 mm

PUR gluing of the whole construction.

The functionality, withstand capability, weathering qualities of the surfaces, and all the other characteristics which can be expected of an entry door, depend on the adherence of technical guidelines, coatings on dimensionally stable external parts made of wood, especially on windows and outside doors. Leaflet no. 18 and VOB (German Construction Contract Procedures) part A 10.3 as well as the RAL quality and test requirements for the construction of wooden entry doors RAL GZ 996. The application recommendations for external building elements from the ift-Rosenheim and VFF-Frankfurt am Main, as well as the guidelines of the EN 14351-1:2006+A1:2010 have imperatively to be maintained.

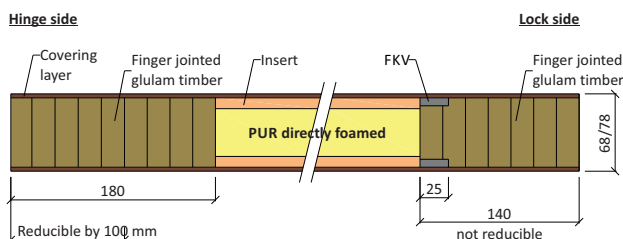
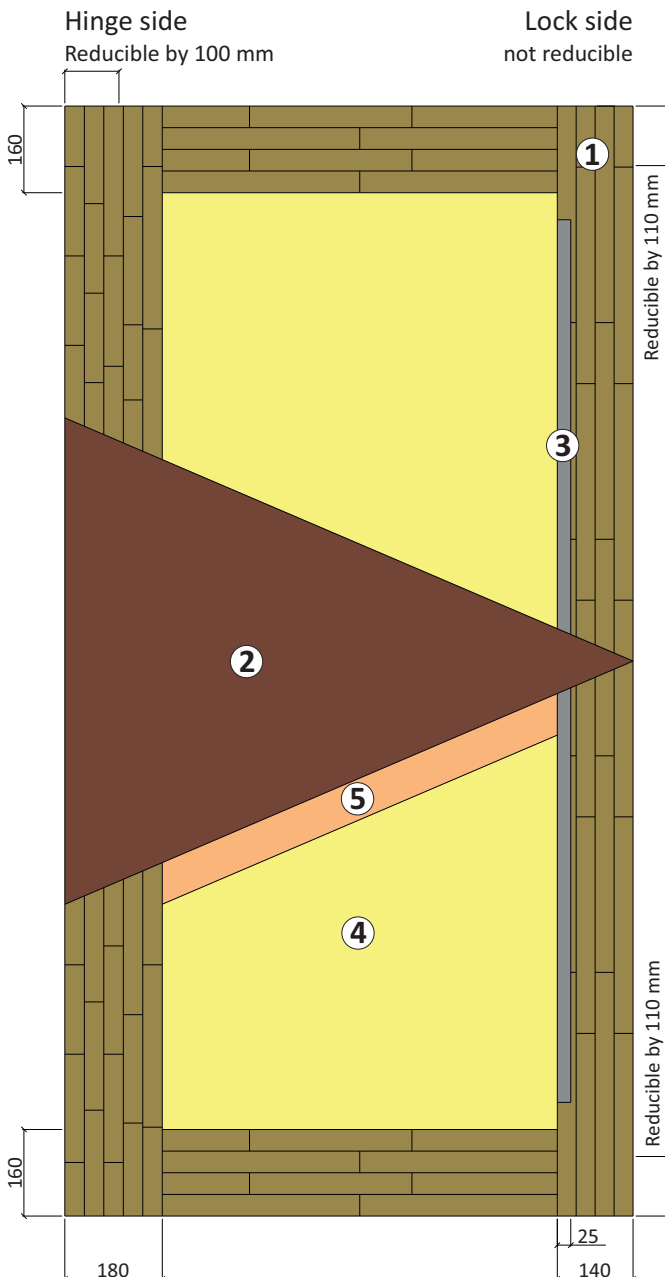

Technical modifications excepted!