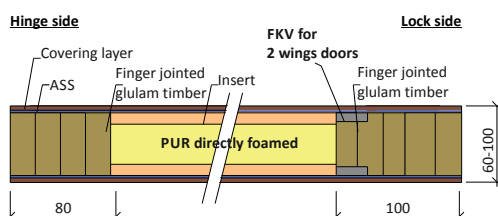
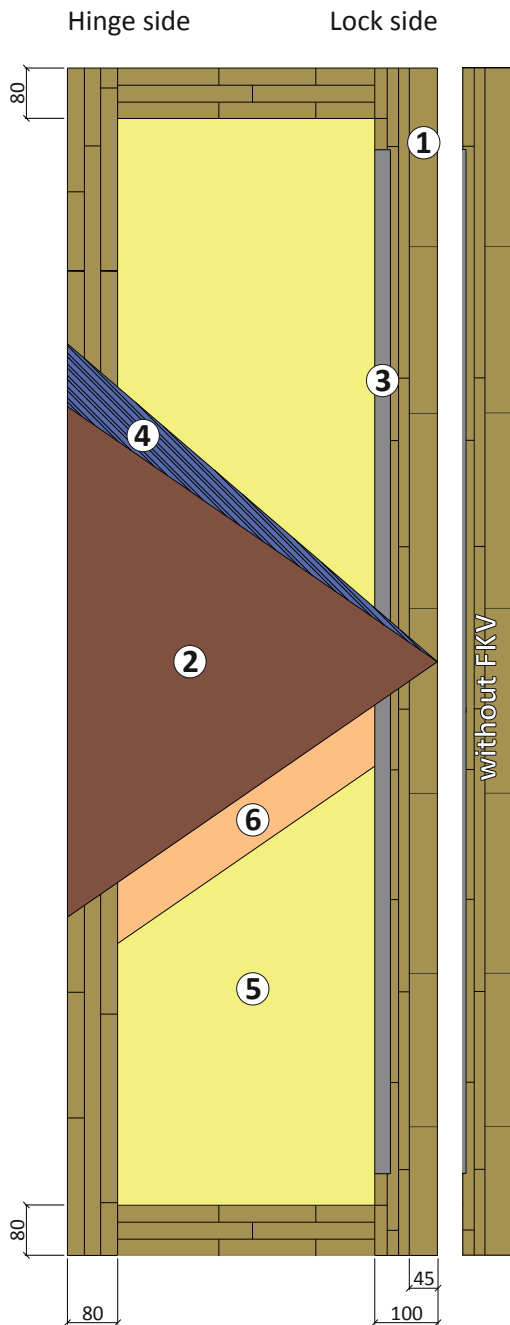

Insulated side part blank (without FKV) in the thicknesses: 60-100 mm

For fixed side parts with FKV for 2-wing doors

 EN 14351-1

Custom-made

1. Wing frame

- Lock side: lamellas in type of wood/colour matching the covering layer. Width approx. 45 mm, glued to inner frame
- Hinge side: flawless glulam timber concealed edge band, type of wood as lock side
- Above: flawless glulam timber concealed edge band, type of wood as lock side, finger jointed
- Below: 80 mm glulam timber concealed edge band according to factory's choice

2. Covering layers (see at page 22 „Plywood covering layers“ data sheet no. 515)

Plywood Exterior glued according to DIN EN 314, class 3, MDF-Exterior with a thickness of 3 and 6 mm. **Water-repellent treatment of MDF with VARIOTEC Protekt, data sheet no. 471.** HPL coating acc. to Exterior collection.

3. FKV technology (Fibre-plastic composite) as a metal-free reinforcement. For 2 wing doors.

4. . ASS Stabilisation layers on both sides, as vapour barrier, gluing is stiff against shearing and tension.

5. Core insulation

PUR construction core, free of CFC, construction-biologically tested, recyclable, jointless and non-positive directly foamed and thus **without thermal bridges.**

6. Internal reinforcement (insert)

Standard: **MFP** (multifunction panel) as a reinforcement for cutouts or as a basis for glazing beads, false edges and glazing beads on both sides. Option: Insert in **plywood** or **MDF** for glazing beads on one side.

PUR gluing of the whole construction.

The functionality, withstand capability, weathering qualities of the surfaces, and all the other characteristics which can be expected of an entry door, depend on the adherence of technical guidelines, coatings on dimensionally stable external parts made of wood, especially on windows and outside doors. Leaflet no. 18 and VOB (German Construction Contract Procedures) part A 10.3 as well as the RAL quality and test requirements for the construction of wooden entry doors RAL GZ 996. The application recommendations for external building elements from the ift-Rosenheim and VFF-Frankfurt am Main, as well as the guidelines of the EN 14351-1:2006+A1:2010 have imperatively to be maintained..