

All-inclusive construction set

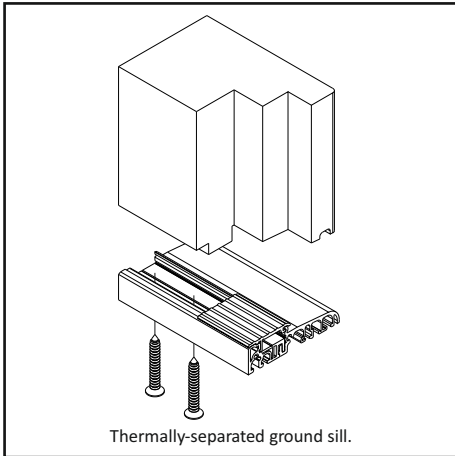

VARIOTEC GmbH & Co. KG | Weißmarterstr. 3-5 | D-92318 Neumarkt i.d.OPf. | Tel.: +49 9181 6946-0 | Fax: +49 9181 6946-50 | info@variotec.de | www.variotec.de



Thermally-separated ground sill.

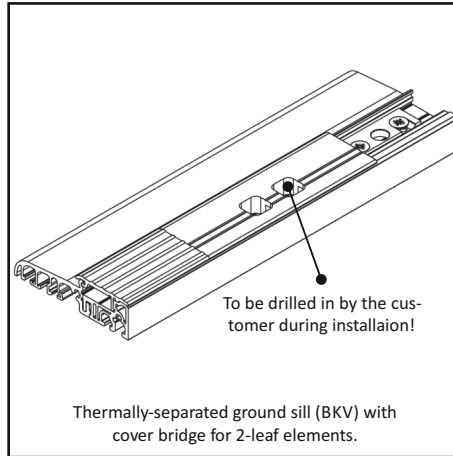

Thermally-separated ground sill (BKV) with cover bridge for 2-leaf elements.

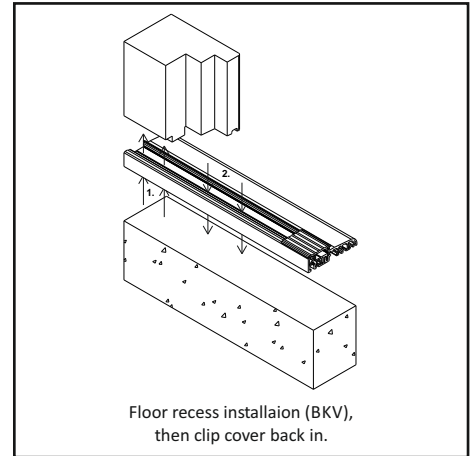

Floor recess installation (BKV), then clip cover back in.

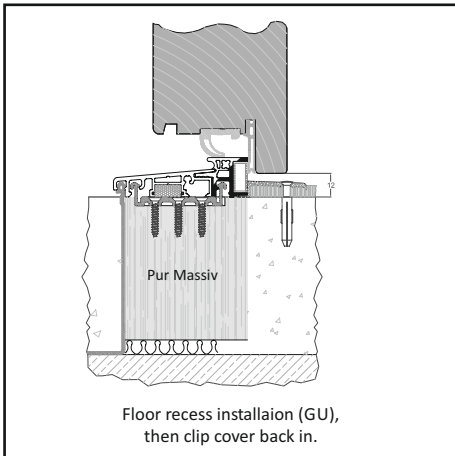

Floor recess installation (GU), then clip cover back in.

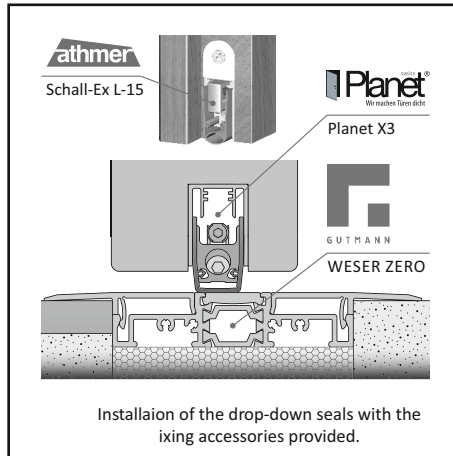

Installation of the drop-down seals with the fixing accessories provided.

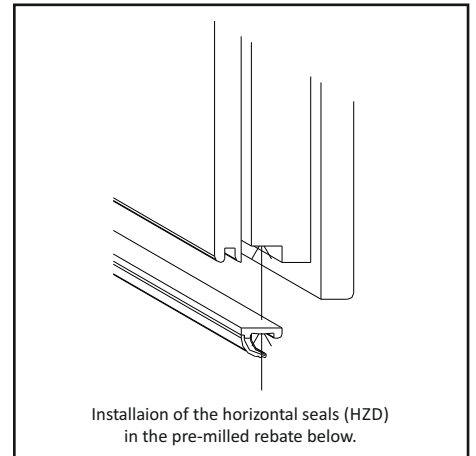

Installation of the horizontal seals (HZD) in the pre-milled rebate below.

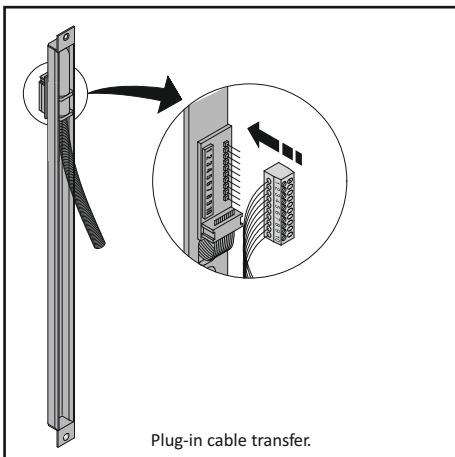

Plug-in cable transfer.

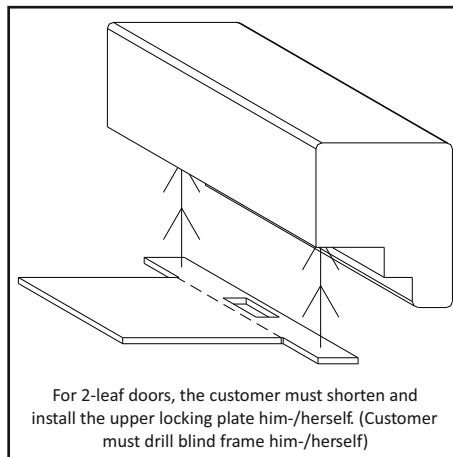

For 2-leaf doors, the customer must shorten and install the upper locking plate him-/herself. (Customer must drill blind frame him-/herself)

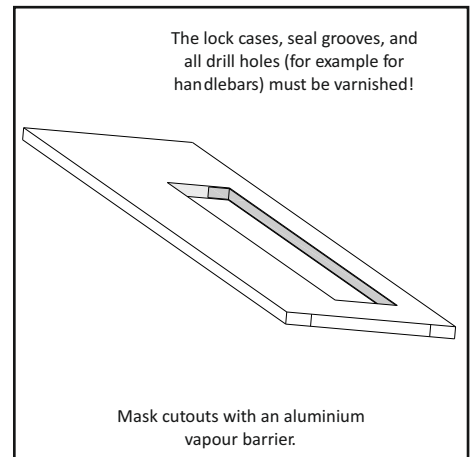

The lock cases, seal grooves, and all drill holes (for example for handlebars) must be varnished!

Mask cutouts with an aluminium vapour barrier.



identification plate MEISTERliche DOOR the rebate during installation!



Keep the locking technology in good condition Oil annually!

Processing of the sealing and compatibility:

1. The sealant may not be overstretched during installation under any circumstances!
2. Coating compatibility: the sealant is made from silicone. Compatible with all environmentally-friendly coatings. You must take note of the drying times stipulated by the coating manufacturers!

Assembly instructions:

1. Begin the assembly in the middle of the upper horizontal planes, press the sealant into the groove in a clockwise direction. The sealant must not be pressed into the groove in the area of approx. 20 cm before the corner area!
2. a) Place the bevel pliers with the stop on the folding corner.
b) Cut the bevel with the bevel pliers at 90°. The cut can only be made up to the kink point (start of the sealing lip). The upper sealing zone (sealing lip) must not be damaged.
c) Set the sealant sharp-edged around the corner and do the same with all corners.
3. The end cut is again made straight. In doing so, please give a 5 mm length allowance.

